



Existing Intersection Conditions

Pedestrian Safety

State Highway 346 runs east and west through the heart of town separating neighborhoods from popular destinations and causing unsafe pedestrian crossings. The Iowa Department of Transportation suggests the following options for making safer crossings:

- There are currently pedestrian crossing signs at two locations: the Little Brown Church and the intersection with Catholic Cemetery Road. There is a "School Crossing Ahead" sign at the intersection with Merrill Street. For rural sections with gravel shoulders, the DOT would be responsible for installation and maintenance of signs and crosswalk markings. For urban sections that have curb and gutter drainage, it is the community's responsibility to install and maintain crosswalk markings. The community could work with the DOT to pursue additional crosswalk markings at the intersections of Highway 346 and Andrews and/or Greeley Streets.

- Communities can apply for a DOT permit for a roll-out stop sign to be used for about 45 minutes before and after school on IA Highway 346. It is recommended that an adult crossing guard also be present. A logical intersection for this option would be Greeley and Highway 346. The intersections of Panama and Greeley Streets have a four-way stop already; better enforcement is needed.
- Communities can work with the DOT to install vertical, narrow "Yield to Pedestrians" signs in the center line of the road, as people have seen along Highway 3 in Waverly.
- Solar powered programmable flashing lights can also be installed to slow traffic down by 10 mph for 45 minutes before school and after school. This would slow traffic from 35 to 25 mph at those times. The DOT would pay for installation and the city would be responsible for maintenance. This requires an agreement with the Iowa DOT.
- Traffic signals for vehicular traffic must meet warrants, meaning the traffic volumes must meet certain criteria in terms of peak hours, volume per hour and the number of hours met, volume per intersection leg, etc.
- Overall, a logical starting point is for the city to pursue painting the crosswalks and installing the center line vertical pedestrian signs. An educational campaign could be done at the school for students.
- For all sign and crosswalk options, Bob Clark is the DOT staff person to contact.

New commercial developments near the intersection of State Highway 346 and Amherst Boulevard have no sidewalks, making access difficult and unsafe for pedestrians. A proposed sidewalk to provide safe access the Dollar General Store, Subway, and Welcome Center is shown on the plan. The property owners would also benefit from the new sidewalks and may be willing to pay for this project.



Enhancements at Intersection of Highway 346 and Greeley Street

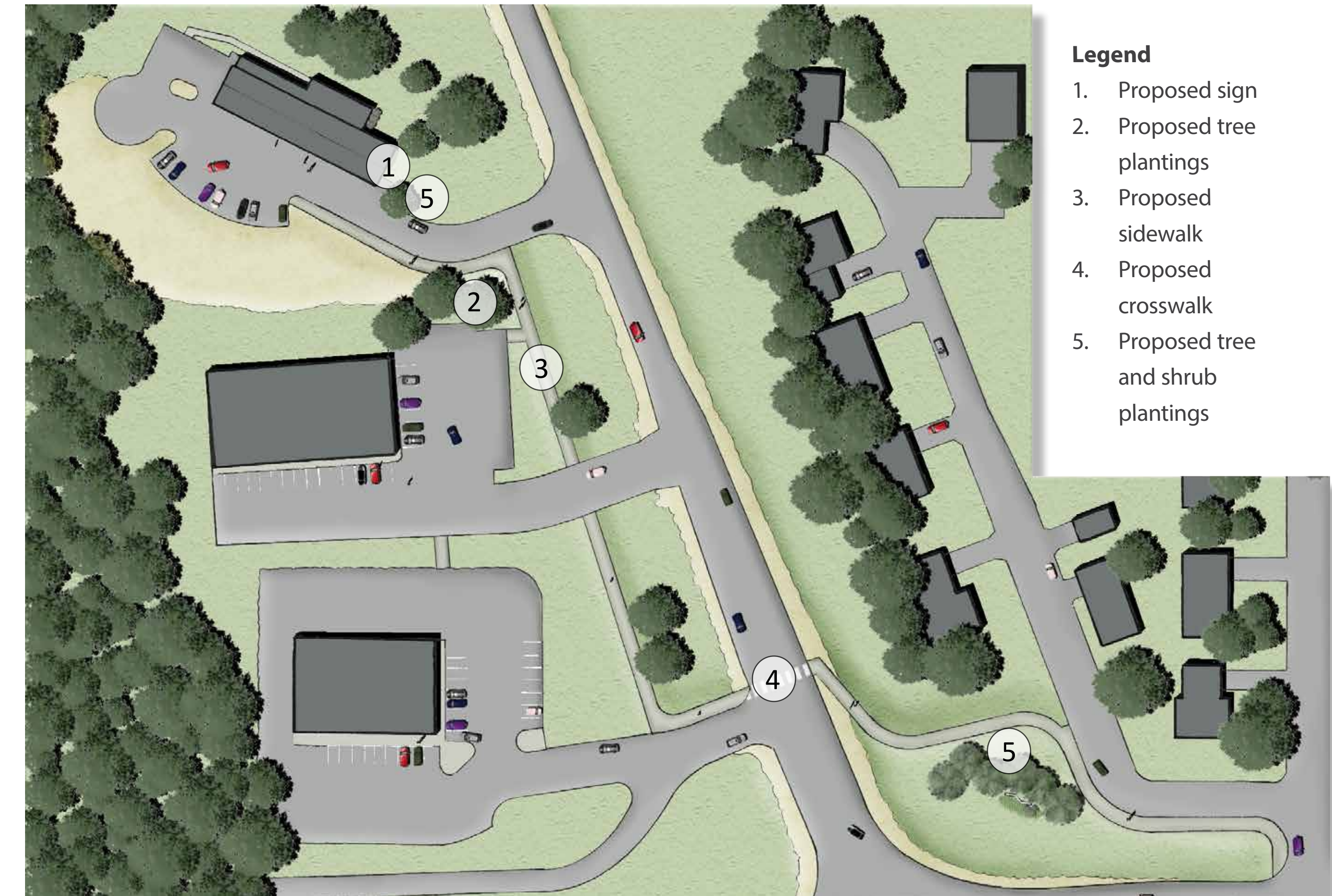

Proposed Enhancements to Welcome Center Connectivity

Nashua

Pedestrian Safety Enhancements

Landscape Architect and Intern: Craig Ritland, PLA, FASLA, Samantha Price, RITLAND+KUIPER Landscape Architects and Katherine Gould

Iowa Department of Transportation Trees Forever ISU Landscape Architecture Extension ISU Extension Community and Economic Development Summer 2015

IOWA'S
LIVING
ROADWAYS